

CLEVIS SLING HOOK

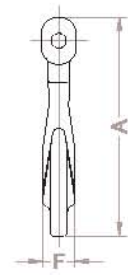
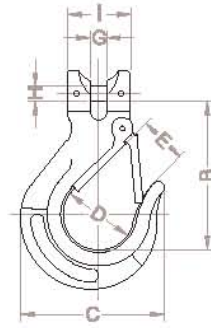

SPECIFICATION

Product Code	Size (Inch)	SWL (WLL) (ton)	Dimension (mm)									Weight (kg)
			A	B	C	D	E	F	G	H	I	
HKCS-001	3/8	3.2	177	120	116	57	41	26	13	12	50	1.2
HKCS-002	1/2	5.4	216	144	140	64	49	30	15	16	59	2.2

- **Material**_ Forged alloy steel
- **Surface**_ Painting
- **Test Load**_ Proof Load = SWL(WLL)×2.5, Breaking Load = SWL(WLL)×4
- **ETC**_ For Grade 80 or, 70 Chain Sling

ITALY CLEVIS GRAB HOOK

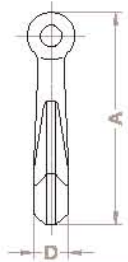
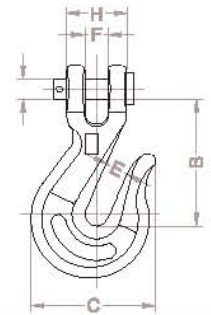

SPECIFICATION

Product Code	Size (Inch)	SWL (WLL) (ton)	Dimension (mm)								Weight (kg)
			A	B	C	D	E	F	G	H	
HKIT-001	5/16	2	92	50	53	31	10.2	10.2	9	37	0.4
HKIT-002	3/8	3.2	125	72	71	43	12.7	12.7	11	47	0.8
HKIT-003	1/2	5.4	155	90	90	52	16.7	16.7	16	56	1.5

- **Material**_ Forged alloy steel
- **Surface**_ Painting
- **Test Load**_ Proof Load = SWL(WLL)×2.5, Breaking Load = SWL(WLL)×4
- **ETC**_ For Grade 80 or, 70 Chain Sling

CLEVIS SLIP HOOK

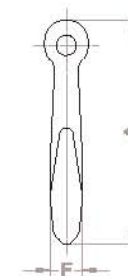
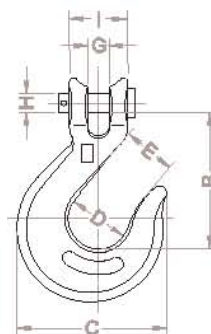

SPECIFICATION

Product Code	Size (Inch)	SWL (WLL) (ton)	Dimension (mm)									Weight (kg)
			A	B	C	D	E	F	G	H	I	
HKSL-001	3/8	2.4	132	81	88	36	32	19	12.5	11	35	0.7

- **Material**_ Forged alloy steel
- **Surface**_ Painting
- **Test Load**_ Proof Load = SWL(WLL)×2.5, Breaking Load = SWL(WLL)×4